

6 BEDFORD FARMS DRIVE
BEDFORD, NEW HAMPSHIRE

SUBLEASE
± 22,860 SF

**WILLIAM
& REEVES**
COMMERCIAL REAL ESTATE



OFFICE

Building Size:

89,110 SF

Available Space:

2nd Floor:

Suite 220: ± 22,860 SF

Class of Space: A

No. of Stories: 2

Elevators:

One (1) passenger

Parking:

304 Parking Spaces

HVAC:

Rooftop AC Units with
VAV

Power:

National Grid, 1,200 amps @480v,
3-Phase

Sewer:

Municipal: Town of
Bedford

Roof:

Fully adhered TPO
membrane

Connectivity:

Comcast High Speed Broadband

Year Built:

1986

Highlights:

- Established campus environment
- On-site property management
- Shower/locker room facilities
- > 5.0 miles to Manchester-Boston Regional Airport

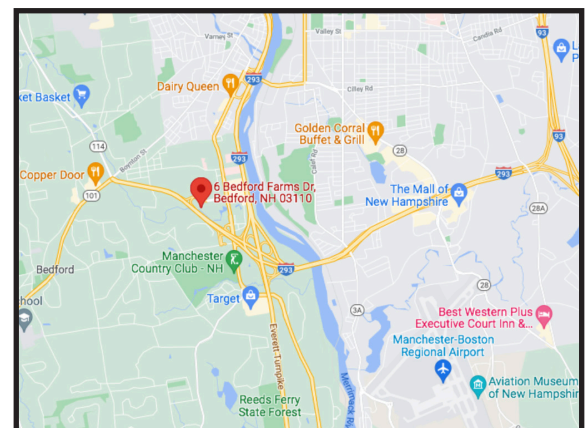

DEANE NAVAROLI

CELL: 603.315.0808

EMAIL: DEANE@WRCRE.COM

OFFICE: 603.935.8939

WRCRE.COM

PROPERTY DESCRIPTION

6 Bedford Farms is a ± 89,110 square foot, two story office building in thriving Bedford, NH. The second floor of the eastern wing of this prominent office building immediately off the Route 101 Kilton Road / South River Road exit is available for sublease and is comprised of approximately ± 22,860 SF. 6 Bedford Farm's location provides exceptional access and easy commutes via I-293 and NH Routes 3 and 101, in addition to an abundance of nearby amenities and services, including Whole Foods, Target, Lowe's, and a number of popular local restaurants.

This suite boasts excellent glass-line, a high-end kitchenette, in-suite & common area restrooms, and abundant natural light. The square footage and open floor plan of this space allow for future users to readily configure the space to best suit their needs. Private offices, conference rooms, breakout rooms, and lots of open area allows for easy employee collaboration and allows for ample room between employee workspaces. The current tenant's fun, modern amenities, furniture, fixtures, and equipment, with the exception of the leased copier/printer and vending equipment, will remain, making this an excellent turn-key option.

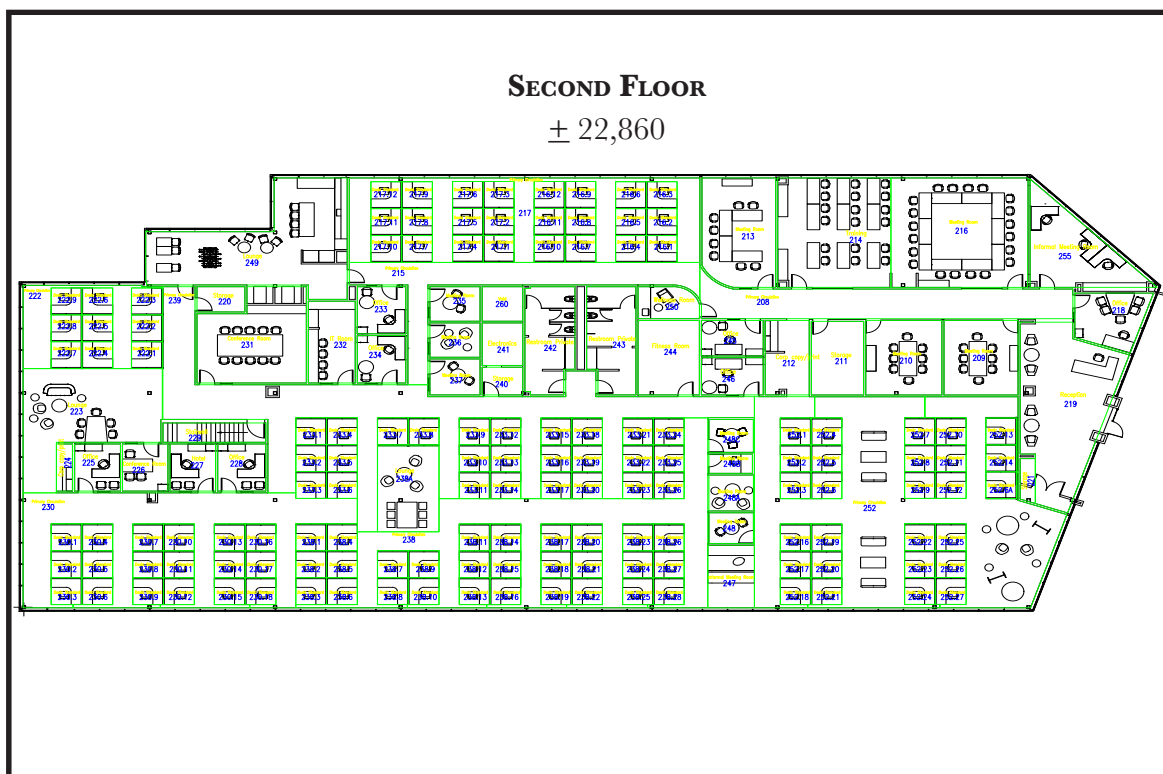

DEANE NAVAROLI

CELL: 603.315.0808

EMAIL: DEANE@WRCRE.COM

OFFICE: 603.935.8939

WRCRE.COM

6 BEDFORD FARMS DRIVE
BEDFORD, NEW HAMPSHIRE

SUBLEASE
± 22,860 SF

**WILLIAM
& REEVES**
COMMERCIAL REAL ESTATE



DEANE NAVAROLI
CELL: 603.315.0808
EMAIL: DEANE@WRCRE.COM

OFFICE: 603.935.8939

WRCRE.COM

This information has been secured from sources William and Reeves believes to be reliable, however, makes no representations or warranties, expressed or implied, as to the accuracy of the information. References to square footage or age are approximate. Purchaser/Tenant must verify the investment and property information and bears all risk of any inaccuracies.

6 BEDFORD FARMS DRIVE
BEDFORD, NEW HAMPSHIRE

SUBLEASE
± 22,860 SF

**WILLIAM
& REEVES**
COMMERCIAL REAL ESTATE



DEANE NAVAROLI

CELL: 603.315.0808

EMAIL: DEANE@WRCRE.COM

OFFICE: 603.935.8939

WRCRE.COM

This information has been secured from sources William and Reeves believes to be reliable, however, makes no representations or warranties, expressed or implied, as to the accuracy of the information. References to square footage or age are approximate. Purchaser/Tenant must verify the investment and property information and bears all risk of any inaccuracies. 11.21



NEW HAMPSHIRE REAL ESTATE COMMISSION

121 South Fruit Street, Ste 201 Concord, NH 03301 Tel.: (603) 271-2701

BROKERAGE RELATIONSHIP DISCLOSURE FORM

(This is Not a Contract)

*This form shall be presented to the consumer at the time of first business meeting,
prior to any discussion of confidential information*

Right Now You Are A Customer

As a customer, the licensee with whom you are working is not obligated to keep confidential the information that you might share with him or her. As a customer, you should not reveal any confidential information that could harm your bargaining position.

As a customer, you can expect a real estate licensee to provide the following customer-level services:

- To disclose all material defects actually known by the licensee pertaining to the on-site physical condition of the real estate;
- To treat both the buyer/tenant and seller/landlord honestly;
- To provide reasonable care and skill;
- To account for all monies received from or on behalf of the buyer/tenant or seller/landlord relating to the transaction;
- To comply with all state and federal laws relating to real estate brokerage activity; and
- To perform ministerial acts, such as showing property, preparing and conveying offers, and providing information and administrative assistance.

To Become A Client

Clients receive more services than customers. You become a client by entering into a written contract for representation as a seller/landlord or as a buyer/tenant.

As a client, in addition to the customer-level services, you can expect the following client-level services:

- Confidentiality;
- Loyalty;
- Disclosure;
- Lawful Obedience; and
- Promotion of the client's best interest.

For seller/landlord clients this means the agent will put the seller/landlord's interests first and work on behalf of the seller/landlord.

For buyer/tenant clients this means the agent will put the buyer/tenant's interest first and work on behalf of the buyer/tenant.

Client-level services also include advice, counsel and assistance in negotiations.

**For important information about your choices in real estate relationships,
please see page 2 of this disclosure form.**

I acknowledge receipt of this disclosure as required by the New Hampshire Real Estate Commission (Pursuant to Rea 701.01).

I understand as a customer I should not disclose confidential information.

Name of Consumer (Please Print)

Name of Consumer (Please Print)

Signature of Consumer

Date

Signature of Consumer

Date

Provided by: _____

Licensee

Date

(Name of Real Estate Brokerage Firm)

Consumer has declined to sign this form.

(Licensees Initials)

To check on the license status of a real estate firm or licensee go to www.nh.gov/nhrec. Inactive licensees may not practice real estate brokerage.

Types of Brokerage Relationships commonly practiced in New Hampshire

SELLER AGENCY (RSA 331-A:25-b)

A seller agent is a licensee who acts on behalf of a seller or landlord in the sale, exchange, rental, or lease of real estate. The seller is the licensee's client and the licensee has the duty to represent the seller's best interest in the real estate transaction.

BUYER AGENCY (RSA 331-A:25-c)

A buyer agent is a licensee who acts on behalf of a buyer or tenant in the purchase, exchange, rental, or lease of real estate. The buyer is the licensee's client and the licensee has the duty to represent the buyer's best interests in the real estate transaction.

SINGLE AGENCY (RSA 331-A:25-b; RSA 331-A:25-c)

Single agency is a practice where a firm represents the buyer only, or the seller only, but never both in the same transaction. Disclosed dual agency cannot occur.

SUB-AGENCY (RSA 331-A:2, XIII)

A sub-agent is a licensee who works for one firm, but is engaged by the principal broker of another firm to perform agency functions on behalf of the principal broker's client. A sub-agent does not have an agency relationship with the customer.

DISCLOSED DUAL AGENCY (RSA 331-A:25-d)

A disclosed dual agent is a licensee acting for both the seller/landlord and the buyer/tenant in the same transaction with the knowledge and written consent of all parties.

The licensee cannot advocate on behalf of one client over another. Because the full range of duties cannot be delivered to both parties, written informed consent must be given by all clients in the transaction.

A dual agent may not reveal confidential information without written consent, such as:

1. Willingness of the seller to accept less than the asking price.
2. Willingness of the buyer to pay more than what has been offered.
3. Confidential negotiating strategy not disclosed in the sales contract as terms of the sale.
4. Motivation of the seller for selling nor the motivation of the buyer for buying.

DESIGNATED AGENCY (RSA 331-A:25-e)

A designated agent is a licensee who represents one party of a real estate transaction and who owes that party client-level services, whether or not the other party to the same transaction is represented by another individual licensee associated with the same brokerage firm.

FACILITATOR (RSA 331-A:25-f)

A facilitator is an individual licensee who assists one or more parties during all or a portion of a real estate transaction without being an agent or advocate for the interests of any party to such transaction. A facilitator can perform ministerial acts, such as showing property, preparing and conveying offers, and providing information and administrative assistance, and other customer-level services listed on page 1 of this form. This relationship may change to an agency relationship by entering into a written contract for representation, prior to the preparation of an offer.

ANOTHER RELATIONSHIP (RSA 331-A:25-a)

If another relationship between the licensee who performs the services and the seller, landlord, buyer or tenant is intended, it must be described in writing and signed by all parties to the relationship prior to services being rendered.